

BOLT-THROUGH

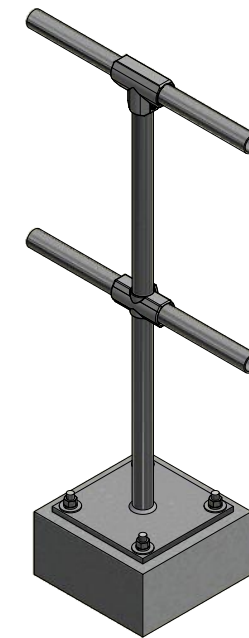

ADHESIVE

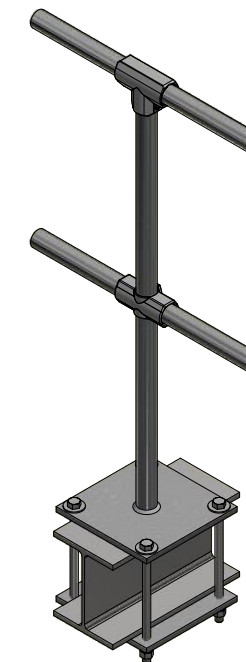

BEAM WRAP

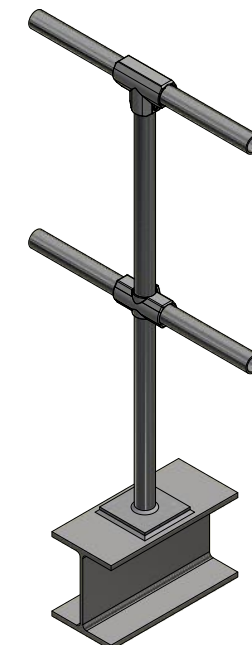

WELDABLE

DESIGN NOTES:

1. DESIGNED TO COMPLY WITH OSHA CFR 29-1910.23.
2. RAILINGS AND POSTS SHALL BE GALVANIZED STEEL PIPE. POST SPACING SHALL BE A MAXIMUM OF 8'-0".
3. RAILINGS AND POSTS SHALL BE CONNECTED WITH GALVANIZED STEEL COMPONENT FITTINGS AS INDICATED. ALL COMPONENTS MUST BE MECHANICALLY FASTENED WITH HARDWARE INDICATED AND TIGHTENED TO 29 FT-LBS.
4. GUARDRAILS ARE DESIGNED TO WITHSTAND A 200 LB CONCENTRATED LOAD IN ANY DIRECTION AT ANY POINT ALONG THE TOP RAIL. WHEN REQUIRED FOR IBC APPLICATIONS, GUARDRAIL MAY BE DESIGNED FOR A NON-CONCURRENT 50 LB/FT UNIFORM LOAD APPLIED IN ANY DIRECTION AT ANY POINT ALONG THE TOP RAIL.
5. TOP EDGE HEIGHT OF TOP RAIL IS TO BE INSTALLED BETWEEN 39 AND 45 INCHES ABOVE THE WALKING/WORKING LEVEL.

GENERAL MATERIAL SPECIFICATION:

STEEL PIPE:	ASTM A500 (FY = 42 KSI)
STEEL CHANNEL:	ASTM A36 (FY = 36 KSI)
STEEL PLATE:	ASTM A572 GR 50 (FY = 50 KSI)
SS BOLTS:	TYPE 304 (FY = 35 KSI, FU = 72.5 KSI)
SS THREADED ROD:	TYPE 304 (FY = 50 KSI)
GALVANIZED BOLTS:	ASTM A307A (FU = 60 KSI)

SERIES NAME: ROOF MOUNT GUARDRAIL - GALVANIZED

SERIES NUMBER: RM-GR-1000-GALV

RATED LOAD: 50 LBS/FT OR 200 LBS CONCENTRATED LOAD

THESE DRAWINGS ARE THE PROPERTY OF PEAK FALL PROTECTION LLC, AND SHALL NOT BE USED, COPIED, OR REPRODUCED WITHOUT WRITTEN PERMISSION.



A Diversified Fall Protection Company

INFO@PEAK-FP.COM

PH 866-387-9965

WWW.PEAK-FP.COM