

DESIGN NOTES:

1. DESIGNED TO COMPLY WITH OSHA CFR 29-1910.23.
2. RAILINGS AND POSTS SHALL BE 1-1/4" SCHEDULE 40 GALVANIZED STEEL PIPE (1.66" OD). POST SPACING SHALL BE A MAXIMUM OF 8'-0".
3. RAILING AND POSTS SHALL BE CONNECTED WITH GALVANIZED STEEL COMPONENT FITTINGS AS INDICATED. ALL COMPONENTS MUST BE MECHANICALLY FASTENED WITH HARDWARE INDICATED AND TIGHTENED TO 29 FT-LBS.
4. GUARDRAILS ARE DESIGNED TO WITHSTAND A 200 LB CONCENTRATED LOAD OR A NON-CONCURRENT 50 LB/FT UNIFORM LOAD APPLIED IN ANY DIRECTION AT ANY POINT ALONG THE TOP RAIL.
5. TOP EDGE HEIGHT OF TOP RAIL IS TO BE INSTALLED BETWEEN 39 AND 45 INCHES ABOVE THE WALKING/WORKING LEVEL.

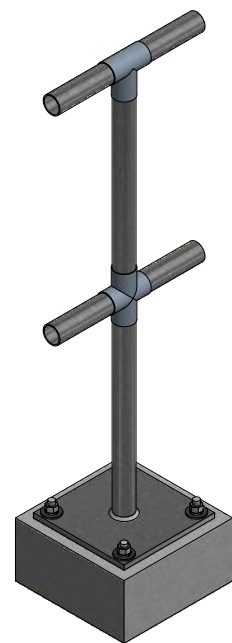

Adhesive

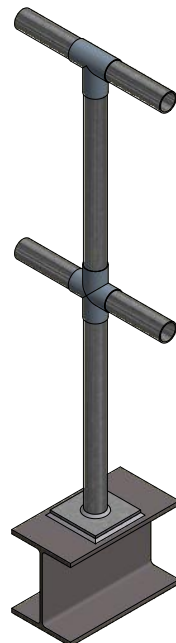

Weldable

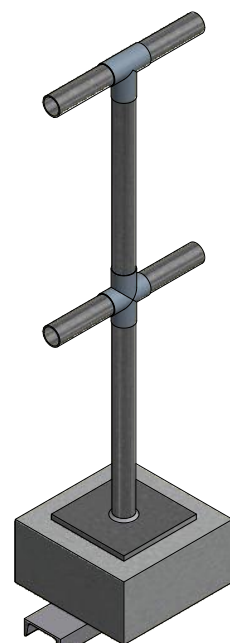

Bolt Through

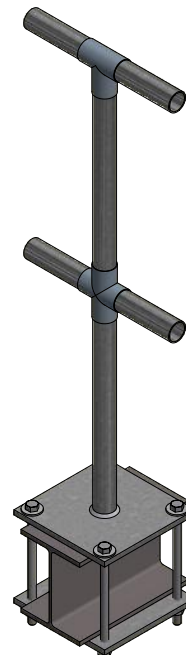

Beam Wrap

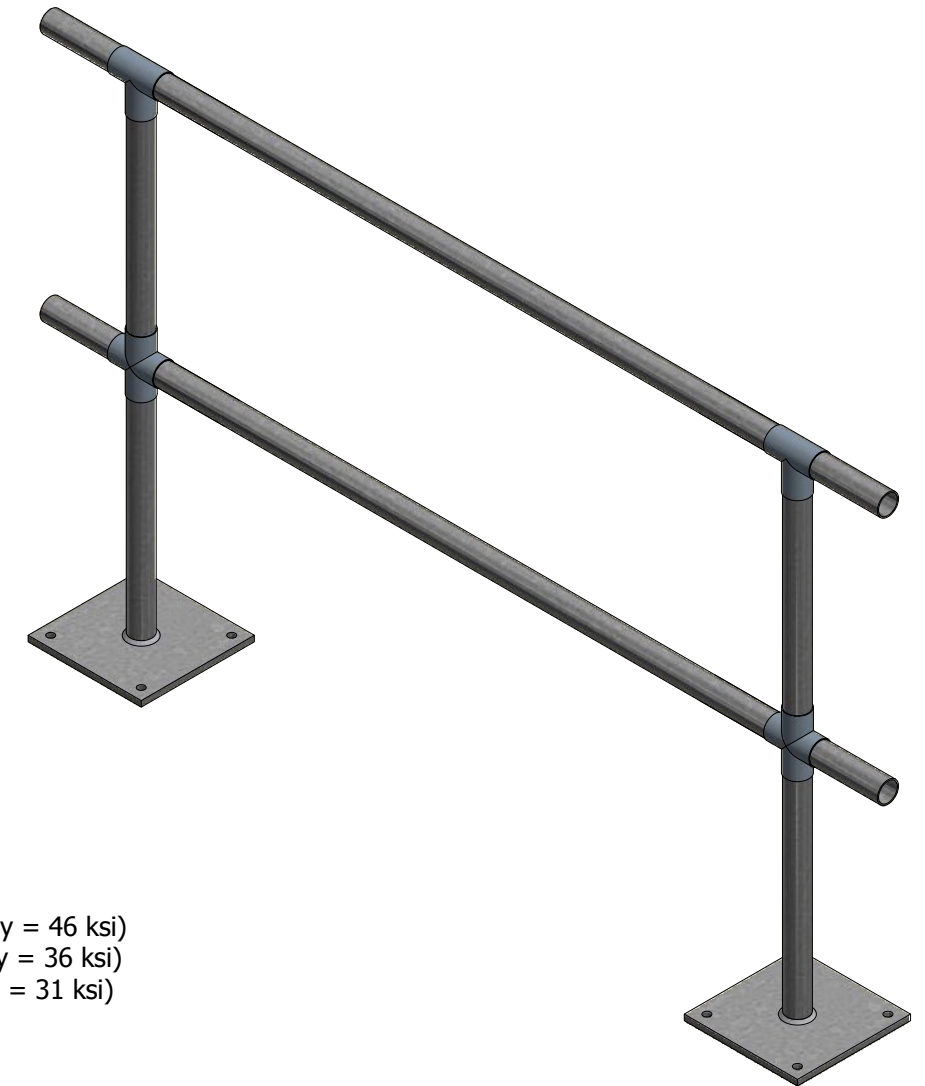

GENERAL MATERIAL SPECIFICATION

STEEL PIPE: ASTM A53 (Fy = 46 ksi)
 STEEL PLATE: ASTM A36 (Fy = 36 ksi)
 STAINLESS STEEL: TYPE 304 (Fy = 31 ksi)

Series Name: Roof Mount Guard Rail - Galvanized
 Series Number: RM-GR 1000-GALV

Rated Load: 50 lbs/lf OR 200 lbs Concentrated Load

THESE DRAWINGS ARE THE PROPERTY OF PEAK FALL PROTECTION INC., 1230 PERRY RD APEX N.C. 27502, AND SHALL NOT BE USED, COPIED, OR REPRODUCED WITHOUT WRITTEN PERMISSION.



PEAK FALL PROTECTION

DESIGNED SAFETY SOLUTIONS

1230 PERRY RD. APEX, NC 27502

PH 866-387-9965 FAX 919-387-9914

WWW.PEAK-FP.COM